

CUBE SAVOGNIN

CUBE SAVOGNIN is located in the fantastic mountain world in the Surses Region in the **South-Eastern Swiss canton of Grisons** (Graubünden). The sport & design hotel is located **directly next to the lift base station and the attractive bathing lake** and is the perfect starting point for nature lovers and sports enthusiasts.

Due to the **impressive location next to the lake at 1,200 m above sea level** CUBE SAVOGNIN established itself as an unique „home base“ for **events, fashion shows, incentives, meetings and team-buildings** (you can reach the rope course with the cable car directly from CUBE)



SAVOGNIN
cube-hotels.com

CUBE FACTS

- Located directly next to the lift base station
- **At the lake** (beach volleyball, BBQ, minigolf)
- **Catering:** 24h Bar, self-service restaurant, à la carte restaurant
- **Chill Out Lounges** on every floor
- **Lobby with open fireplace and video wall**
- **Relax Area** with sauna, steam bath, infrared cabin, retreat area, Alpha Loungers and solarium
- **Fitness Area** with state-of-the-art cardio and fitness machines including flat screen TVs
- 757 m² **sun terrace**
- 173 m² **rooftop terrace**
- **Gaming Zone:** Darts, table football, billiards, ...
- **W-LAN**
- **Ramps and toilets with wheelchair access**

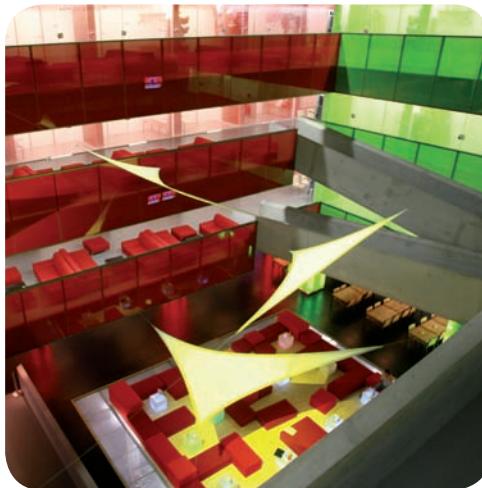

Capacities & Accommodation

CATEGORY	NUMBER
Room for 2 pers.	17
Room for 2/4 pers. (grandlit + a pair of bunk beds)	39
Room for 4 pers. (two pairs of bunk beds)	18
CUBE Suite (2 pers. + extra bed)	2
Rooms all categories in total	76
Beds all categories in total	270

All rooms with shower and separate toilet, blow-dryer and flat screen TV.
There is a own **Showroom** to store your sports gear and dry your clothes.



Seminar rooms & CUBE Club

- **1 seminar room (158 m²)** with natural daylight and standard equipment (flip chart, beamer)

Seating arrangement & seats available:

Parliament	School	Cinema	U-Shape	Boardroom
56	49	130	51	58

- **CUBE Club:** 500 m² total area, 2 bars, 1 stage, lounges and state-of-the-art sound and lighting equipment
- **Extravagant branding:** plasma screens, video walls and projection of corporate image and colours on façade, logos/slogans inside and outside



SOCIAL PROGRAMME - SUMMER

- **FUN SPORTS:** Downhill tour with Mountain Roller, Trottnett and more
- **Rope course with Switzerland's longest flying fox** (from CUBE with the cable car directly to the rope course)
- **Olympiades at the lake** powered by NTC Sport
- **Water Jump Contest at the lake**
- **18-hole golf course** Alvaneu Bad
- **Biking:** 240 km of signposted MTB routes, downhill run and bike parcours
- **Senda ferrada at Piz Mitgel** for all levels of difficulty to 1,320 m above sea level
- **Rafting & canyoning in Rhine Canyon**

SOCIAL PROGRAMME - WINTER

- **Skiing & snowboarding on 80 kilometres of piste** with 13 modern lift facilities
- **CUBE FUN SPORTS:** Try the latest fun sports like snowbike, ski fox and more
- **Ski & snowboard races**
- **FUN SPORTS contest**
- **Snow shoe hikes:** e.g. guided moonlight hike
- **Schlittada Run:** this cool toboggan run leads 4 km nonstop down the hill
- **On the ice:** natural ice field for curling and ice skating (Skateline Albula - 3 km long ice alley through the snowy forests)
- **Toboggan and 44 km of cross-country tracks**

LOCATION & ACCESSIBILITY

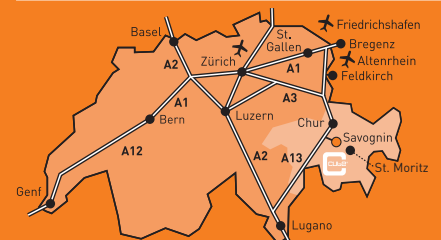

EASILY ACCESSIBLE: Motorway A13 direction Chur/San Bernadino, exit Thisis direction St. Moritz. Next airports: St. Gallen/Altenrhein (132 km) or Zurich (170 km). Railway station at Tiefencastel. **Plenty of free carparks:** 83 and another 1,500 at the valley station.